

Die Räume im Kurhaus Kirchzarten

- RAPPENECK
- FELDBERG
- RAUM DES GASTES
- KANDEL
- SAAL
- RAUM DREISAMTAL



Beispiele für Bestuhlungen

Raum Rappeneck (OG)

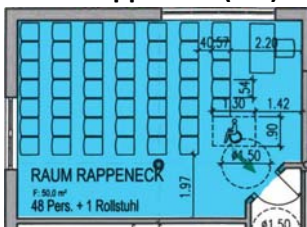

Reihe: 48 Pers., 1 Rollst.

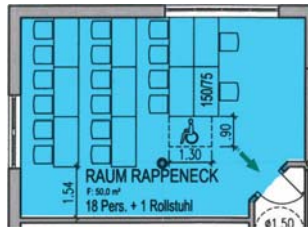

Tische: 18 Pers., 1 Rollst.

Raum Feldberg (OG)

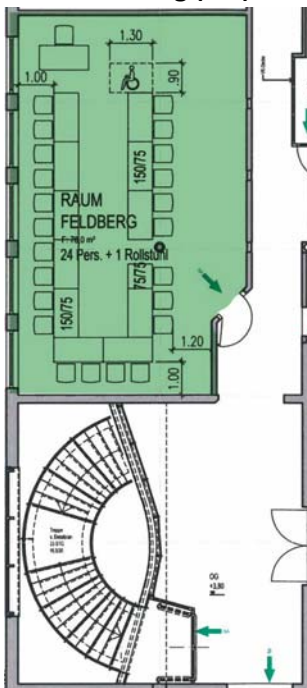

U-Form: 24 Pers., 1 Rollst.

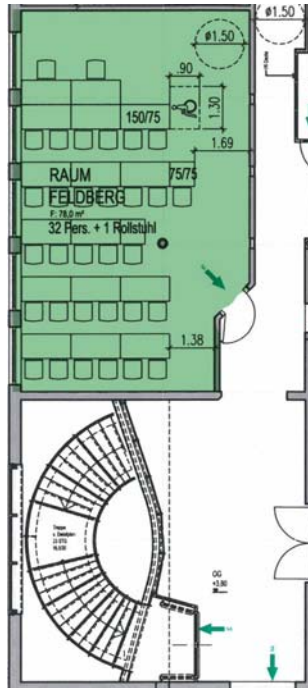

Tische: 32 Pers., 1 Rollst.

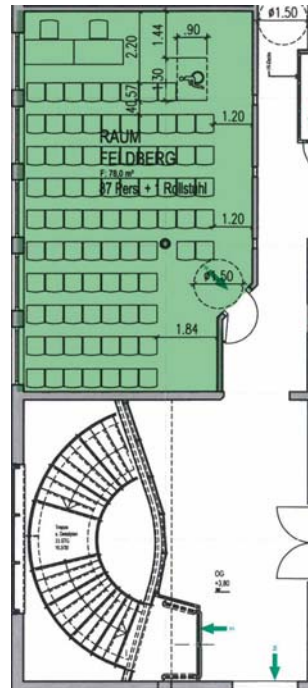

Reihe: 87 Pers., 1 Rollst.

Raum des Gastes (OG)



U-Form: 112 Pers., 1 Rollst.

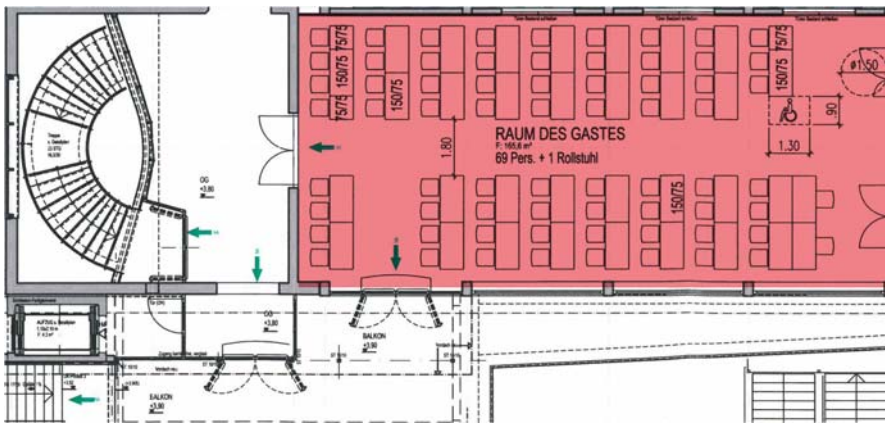

Tische: 69 Pers., 1 Rollst.

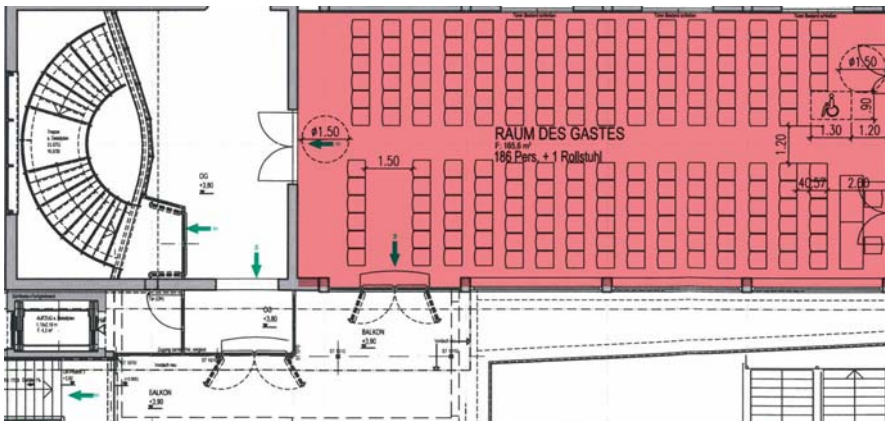

Reihe: 186 Pers. 1 Rollst.

Raum Kandel (OG)

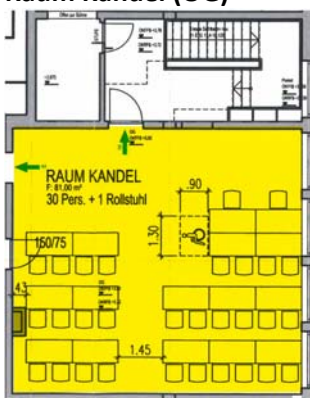

Tische: 30 Pers., 1 Rollst.

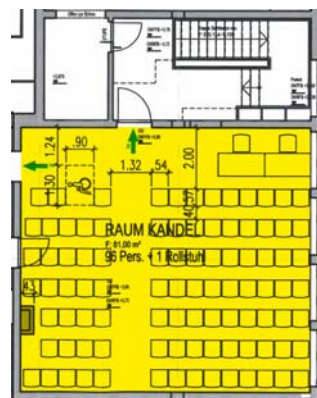

Reihe: 96 Pers., 1 Rollst.

Saal (EG)

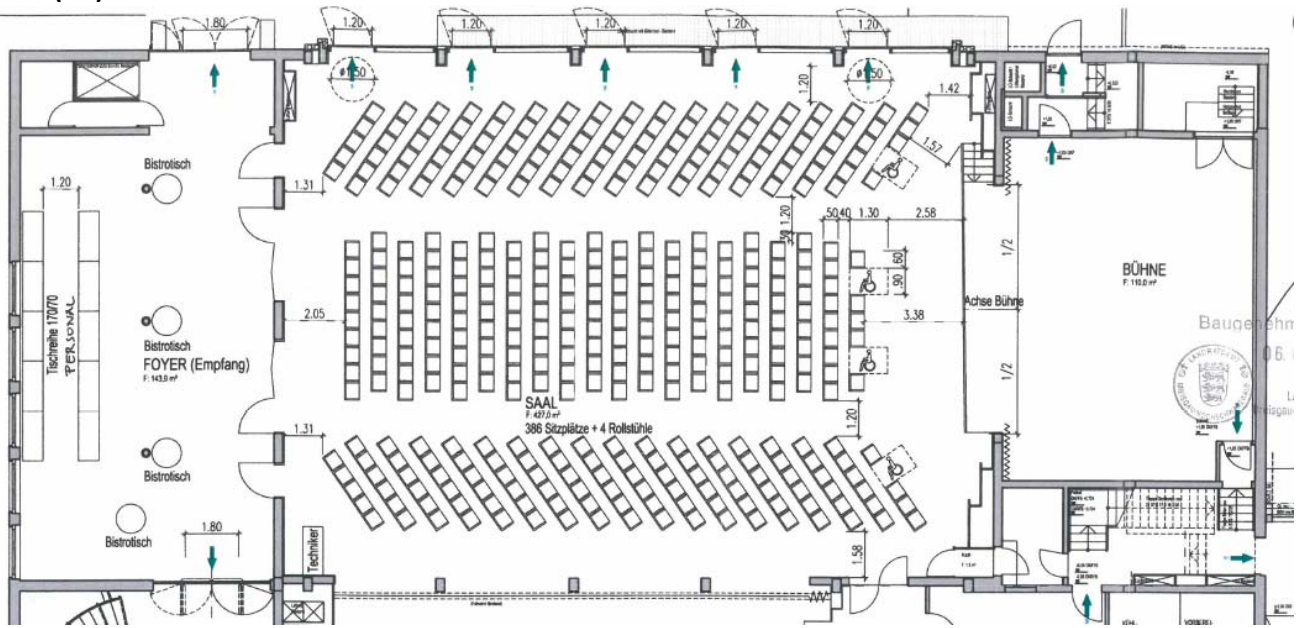

z.B. Reihe: 386 Pers., 4 Rollst.

Raum Dreisamtal (UG)

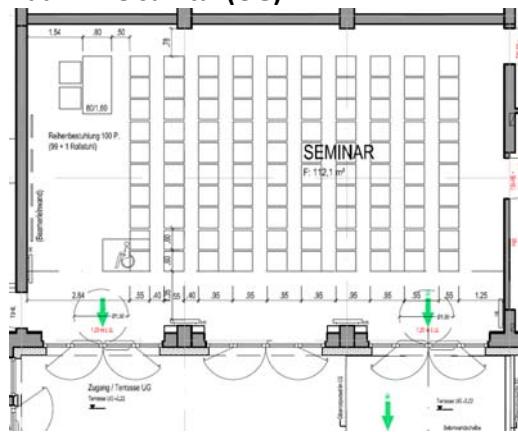

z.B. Reihe: 99 Pers., 1 Rollst.